



Town Council invests in new Queens Avenue play space

At the Town Council meeting on 14th February, plans to install new play equipment which will be installed at the Queens Avenue play area were approved.

The General Purposes Working Group led by Cllr Pete Cox has been working hard to remove unsafe equipment and meeting contractors to discuss new equipment for this area, exploring the potential for further improvements.

The Town Council are keen to hear from residents about how the rest of this space can be used and any further improvements that could be made to the park. Councillors are determined to provide a safe and secure space for everyone to use that will be cost-effective to manage and resilient in all weathers.

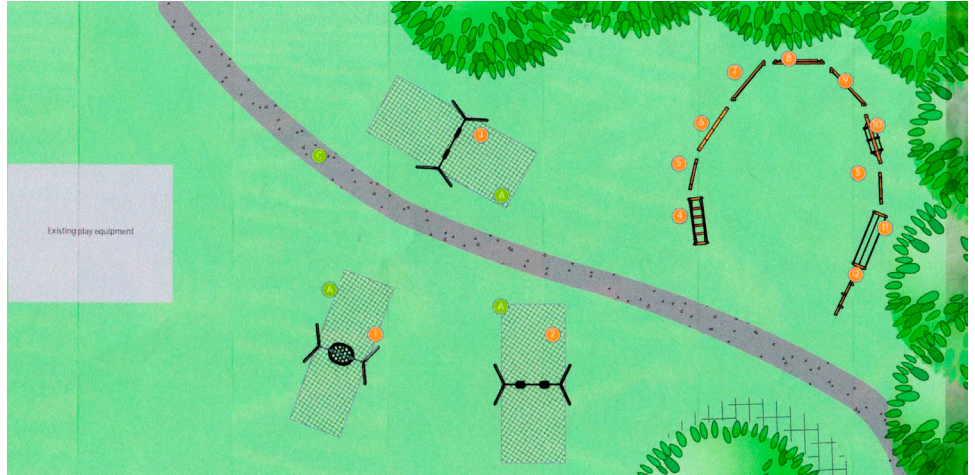

LEGEND

A: Grass matting, C: Existing pathway, 1: Metal nest swing, 2: Metal cradle seat swings, 3: Metal flat seat swings, 4: Wobble walkway, 5: Balance beam, 6: Hanging rope walk, 7: Crossed rope walk, 8: Rock & roll log, 9: Rope walk, 10: Swinging logs, 11: Bridge, 12: Balance weaver

20mph petition presented to County Council

On 9th February, a delegation from Shipston's 20mph Campaign Group presented Cllr Wallace Redford, Warwickshire County Council Cabinet Member for Transport and Planning with a petition signed by 1,080 people from the town.



The petition requests the County Council implement a 20mph speed limit in Shipston subject to discussions with Highways Engineers.

Speedwatch Co-ordinator Jacey Jackson, said: "It was a positive experience talking with Cllr Redford, knowing that Cllr Barker is also taking an interest. Data from Automatic Speed Surveys on London and Stratford Roads are currently being analysed. Early indications are that they, together with data gathered since 2017 by the Shipston Community Speedwatch Team, support the petition for slower speeds through Shipston."

Shipston Town Councillor John Dinnie, said: "Additional traffic calming and enforcement measures would also help to bring down speeds and make Shipston a more pleasant place to walk and cycle."

Tour d'Ilmington set to return!

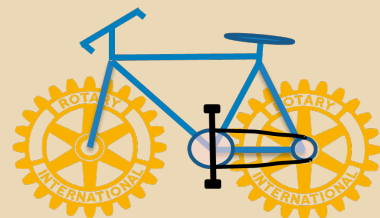

The ever-popular Rotary Cotswold Tour d'Ilmington has become a major event in the South Warwickshire calendar and this year's iteration on Sunday 3rd July promises to be bigger and better than ever.

Enjoy one of the three unique Tour routes. From the shorter and less challenging family ride to the much longer ride for enthusiast cyclists, as well as the one in between.

Hospitality will be provided at the Tour HQ and Tour Village at Newbold-on-Stour Village Hall.

As with previous events, Shipston Rotary will be working hard to make it as environmentally friendly as possible.

Details of how you can reserve your place will be announced soon. Rotary will be making announcements on Facebook and displaying posters in Shipston and the surrounding area.

Mayor's column



The Town Council have been busy with their plans for 2022-23 and beyond, and have set an ambitious budget, which will hopefully enable some positive changes for the Town.

I'd like to thank all the Town Councillors and staff for all their hard work, there has been a lot going on at the same time as we are trying to make our future plans, and I know they have all worked hard towards this.

As I write, we are just getting through our third storm of the week, I hope it has not caused too much hardship or damage in Shipston, but it does serve to remind us how impacted we can be by nature, and how important it is to do all we can to try and protect and preserve our natural environment. This is in our plans for the Town and will be a key focus going forward.

We managed to get a sneak preview of the re-decorated Sports Club building following the floods it suffered and its closure for nearly a year. It's looking fabulous, and I hope it will encourage many more of you to use the facilities, whether participating in sport or just for a social visit - there can be few nicer ways to pass the time than to sit down with a drink and watch some local sport. The sports club, together with the Rugby Club also provide important facilities for our younger residents, and this is another theme that is high on the Town Council's agenda going forward, how we can help provide and improve facilities and opportunities for our youth.

We attended the Whitnash Civic Service this month, it's always useful to talk to the other civic authorities, they all face similar issues and it's good to share ideas. We are holding the Shipston Civic Service on Sunday the 13th March at 2pm at St. Edmunds, everyone is welcome to come and join us in celebrating those that have helped during this difficult period and looking to how we take things forward.

Talking of which, I note, like some of you, that hoardings have gone up outside the Ellen Badger. I'm told that this is as part of the clear out of the old hospital, but eagerly anticipate the start of the work on the new one there, and remain hopeful that this will be a facility that will meet our future needs and we can be proud of for years to come.

Ian Cooper, Mayor of Shipston

Town Council Budget 2022-23

At its January meeting, the Town Council unanimously supported the Finance Working Group (FWG) recommendation to request an annual precept of £276,000 for the 2022-23 budget year. This is an increase of £16,000 over 2021-22 levels, however Ian Cooper chair of the FWG was keen to point out that the increase fully reflected the increase in the number of contributing properties in the Town, and there would therefore be no increase to the average "band D" Town Council element of the Council Tax bill.

The growth in the town over the past few years has necessitated increases in resources for the Town Council, and the budget for 2022-23 includes a provision to strengthen our admin team as well as adding to the level of service that we provide.

The Town Council is maintaining its strong support for organisations that support local community initiatives and which aim to provide identifiable benefits to the community. In addition, the Town Council has set aside money to provide for carrying out larger projects that are required to either protect, maintain or improve the assets of the town. Specifically, there are playground facilities and equipment that will need to be replaced or repaired, we will need to carry out repairs to the Cemetery Chapple and lodge, and we are looking to support projects to improve the Sports Club building, which is under the Town Councils responsibility.

The Town Council will continue to support those community organisations that provide benefits to our local community through grant awards, including Shipston Proms, who will be back again this year and the Town Band, who continue to support town events. Grants have also been recommended for Shipston in Bloom, Community First Responders, Shipston Angling Club, the WI and VASA, as well as funds to assist in the repair of the clock on St Edmunds Church.

We are presenting a challenging budget, with new projects and maintenance at levels not seen before for Shipston, and the hope that it will make a real difference for the Town.

Where does your town council spend its money

	2021/22 Projection	2022/23 Budget
Buildings and maintenance	15%	16%
Community	28%	42%
Staff and agency contracts	41%	50%
Professional support	1%	3%
Civic duties	2%	1%
Publicity	9%	10%
Emergency and other	0%	0%
Reserves	4%	-22%

Where does the money come from

	2021/22 Projection	2022/23 Budget
Council Tax	84%	88%
Government reduction grant	1%	0%
Agency contracts	6%	6%
Rents and lettings	2%	2%
Services and charges	5%	4%
Donations and Grants	0%	0%
S106 receipts	2%	0%
Assets and interest	0%	0%

News from Shipston Town Council's February meeting

Food Festival

Stour Valley Lions had submitted a request to use the High Street for a food festival in September. Councillors agreed that permission should be granted.

Burglaries

Councillors have been contacted by residents to express concerns about several recent reports of burglaries in the town. The Council will be contacting the Warwickshire Police and Crime Commissioner to ask about the possibility of an increased police presence. Useful security advice will also be published on social media and in the Forum.

Ellen Badger Planning Permission

District Councillor Trevor Harvey informed the meeting that he understands planning permission will be granted imminently following final modifications to the Section 106 agreement.

Sewerage Issues

Councillors expressed concern about continued drainage issues across the town and the general state of the sewage system. Representations will be made to Severn Trent Water and the Environment Agency.

Ellen Badger Hospital Review

Councillor John Dinnie planned to attend the Warwickshire Adult Social Care and Health Overview and Scrutiny Committee meeting on 16th February. He intended to make a representation on behalf of the Council to express the strength of feeling across the town about the importance of retaining community hospital inpatient services.

Shipston Area Flood Action Group

Councillors approved the proposed programme for 2022.

20's Plenty for Warwickshire Campaign

All Parish and Town councils in Warwickshire have been invited to pass a motion in support of a countywide initiative to introduce 20mph as the default speed. Councillors declined to pass the motion, and instead expressed a desire to work with the County Council and Police on targeted schemes.

EV Charging Points

A local company has been invited to attend the next meeting of the Planning Committee to discuss a proposal to install charging points in the New Street car park.

Allotment Notice Boards

Authority to purchase new notice boards was delegated to the General Purposes Working Group.

Riverside Project

There are several outstanding issues in the draft lease that require investigation, including potentially exposing the council to unknown liabilities.

Princess Diana Visit

An appeal for photos of the visit and people's recollections of the event on the Council's Facebook page resulted in an article in the Stratford Herald.

Internal Auditor

Trevor Gill was re-appointed as the internal auditor to the Council.

Microsoft 365 Exchange

Email services for Councillors and Staff will be migrated from Google Workspace to Microsoft 365 Exchange.

Staffing Review

A review of staff job descriptions, roles and responsibilities is in progress. Recruitment of additional support via the Kick Start scheme is underway.

Jubilee Working Party

Councillor Ronnie Murphy will chair the working party and organise town-wide commemorations.

What's On Calendar - March 2022

- 28 Feb - 3 Mar** Shipston Home Nursing Pop Up Shop: White Bear Function Room, 10m-3pm. Designer New and 2nd Hand Clothes, Accessories, Jewellery, Bric-a-Brac, Designer fabric samples plus Men's wear
- 2** **Shipston on Stour WI:** Speaker, Ken Ingamells, Scott of the Antarctic. Catholic Church Hall, Darlingscote Road at 7pm. Contact Jane Hanks, Secretary, on 01608 664519
- 3, 10, 17, 24, 31** **Stour Singers:** Rehearsal at Primary School, Station Road, from 7.30 to 9.30pm. New singers are always welcome. Contact Yvonne Ridley, on 01789 369587 www.stoursingers.org.uk
- 4** **Rural Cinema:** Emma: See advert on page 8.
- 10** **Shipston Branch of the RBL Committee Meeting.** All members welcome. Contact Alex Black 01608 664743
- 18** **Shipston Branch of the RBL social evenings:** The Shipston on Stour Branch of the Royal British Legion meet on the third Friday of each month for a social gathering. We meet in the White Bear Inn from 7.30 pm onwards. Do please come and join us and share your stories with like-minded people. For further information contact Alex Black 07789 968733 or alblack32@hotmail.com.
- 22** **Shipston U3A - Open Day:** See advert on page 8.
- 30** **Shipston Literary Society:** Remembering Frank Muir & Dennis Norden – two writers of comedy by David Howe. Meetings are held at the White Hart Inn, Newbold on Stour at 7.30pm. Visitors welcome £5 ea. For further information ring Helen Marshall 01789 740773
- 31** **Local Quaker Meeting for Worship:** St Edmund's Church, last Thursday in the month at 2.30pm, followed by tea/coffee, biscuits & chat

Youth Speaks returns!

Shipston Rotary was delighted to hold its first face to face 'Youth Speaks' debating competition in over two years at the Tim Piggott-Smith Library at King Edward VI School (KES) in Stratford, where four excellent teams gave very competent performances.

This year several schools decided not to enter because of the uncertainties surrounding Covid. However, we were delighted that Mr Nick Abbey, Head of English at KES, was keen, as were the students, to take part in the debating competition at the intermediate level.

Before the start, the library was abuzz with discussion of the thought-provoking debating topics. The winning team was Arnav Mulay (Chair), Youssef Mourkus (Proposer) and Rufus Round (Opposer) whose topic was 'This house believes that animal testing is morally acceptable. They will progress to the Rotary District Round on 19th March.



The other topics were 'Genetic engineering is essential for human progress', 'Space travel is a waste of time and money' and 'the UK should invest in nuclear technology'.

The judges gave the teams excellent feedback and also

commented on how important the return of this competition was for the students, parents and all visitors. Lead adjudicator Garry Flatres expressed his hope that next year's Youth Speaks would attract more teams from other senior schools.



All teams received certificates of participation and the winning team was presented with trophies by David Gill, Shipston Rotary President, and Cliff Armstrong, Stratford Rotary President.

Global Polio Campaign

Many of the Forum's more senior readers will know all about polio. A terrible paralysing disease that killed millions until a vaccine was created in the 1950s.

The worldwide Rotary organisation has been raising funds to pay for polio vaccines to be administered in every corner of the globe since 1985.

The campaign has been incredibly successful. A few years ago India was finally declared polio-free. But the vaccine still must be administered to every child. Shipston Rotarians help with this in the third world occasionally.

Until recently Pakistan and Afghanistan were the only remaining two countries, in the world, still reporting cases. The difficulties encountered by healthcare workers administering the vaccine in those two countries are immense. Many lives of healthcare workers have been lost. But they have courageously persevered.

Pakistan has now been declared polio-free. A fantastic achievement.

Rotary 100 club winners.

The draw was made on January 26th in Napton by Victoria Palmer.

First Prize	£ 66.25 winner No 14
Second Prize	£ 39.75 winner no 16
Third Prize	£ 26.50 winner no 49

Why not have a go, contact Tony Joint: tonyjoint73@hotmail.com

Townsend Hall



From Winter to Spring...

We've been busy through the winter updating our facilities to make the hall an even more attractive proposition for our hirers whatever the size of the event, most recently upgrading the main hall lighting to better support sports and staged events. We have a number of areas available to book and it was great to recently see a family party booking with music and food making excellent use of our reception, smaller hall and kitchen/servy.

On the music front, judging by the ticket sales at the time of writing, it was a fun February with Cotswold Events "Just Take That" tribute and our jazz night with "Tom 'Spats' Langham's Hot Fingers" well attended – check out our FaceBook page for pictures and video captured.

As spring approaches, we're looking forward to Cotswold Events "Elvis Experience" on the 5th March – tickets available from <https://www.ticketsource.co.uk/cotswoldevents>. Our jazz programme also continues on the 18th March with "Richard Leach's Street Band" - tickets from <https://www.ticketsource.co.uk/townsend-hall> or from A. Clarke Electrical Services in town. Take a look at www.richardleachjazz.co.uk to whet your appetite.

Don't forget we're a venue funded as a charity, so keep up your support through your bookings, event attendance and donations - numbers are still available in our "150 club"; and please consider us when shopping through Amazon Smile or one of the many retailers supporting charities through easyfunding.

Winning numbers in the February 150 club draw are: £15 No. 52; £10 No. 111; £5 No 53.

Visit us at www.townsendhall.co.uk to find out more.

Shipston Proms

After many appeals for help, it was brilliant to welcome new member George Kelly to the Shipston Proms committee at our first meeting of the year at the White Bear.



It seems all systems go with planning for this summer's festival made all the easier as we have had the line up more or less in place since 2020. Currently, we have Uncle Funk bringing his Disco Inferno (formerly Wonderband) to Townsend Hall on Launch Night, Friday 10th June. They have appeared at Glastonbury three times in recent years and are guaranteed to have you dancing all night long. 'Dawn 'til Dusk, The Shapes and The RJP Band (otherwise known as the Rick Parfitt Junior Band) are headlining on the Final Night promising a memorable night of rock n roll. On Friday 17th June, there will be a dance party hosted by DJ's Harry Synge and Tim Samsara at the Hub with their trademark pounding techno beats.

Chair Charlotte is talking to Shipston High School plus children's music group Calypso Kids as well as looking into arranging a music recital at church and liaising with Barney Porter for the Open Mic Night. We are talking to venues in and around Shipston including The Hub, the Black Horse, and Talton Mill to see what music can be put on where. When we can, we are going to see bands to see if they are suitable to play during the Proms fortnight. For new ideas for Proms 2022 we are looking into selling Proms T-shirts and having card readers in addition to receiving cash.

We are still looking for more committee members so if anyone would like to get involved, please let us know on shipstonproms@gmail.com. If there are any musicians who would like to take part, please also get in touch. For all updates, please go to shipstonproms.org or our Facebook page.

Dates for this year's festival are 10th – 25th June.

Susan Perry

Shipston Knitting and Crochet Group seeking new members!

All abilities welcome. We are a friendly group that was set up just over 4 years ago and some of us yarn bomb the town. We welcome new members and there is always someone willing to help you to learn to knit or crochet. We would love to see some of you. Monday evening 7-9 in the Servery at the Townsend Hall. Tea or coffee included in £2.00 admission charge.

Lynette Campion

Warwickshire Police remind drivers about mobile phone safety

Warwickshire Police have urged drivers and those supervising learner drivers not to use a handheld mobile phone whilst driving. In addition to being illegal, handheld mobile phone use is one of the top four causes of death and injury on roads, alongside not wearing a seatbelt, drink & drug driving, and speeding.

Officers are also reminding drivers that it is illegal and dangerous to use social media apps, select music, or check emails when driving. In 2021, officers attended three serious and one fatal collision where using a mobile phone whilst driving was a contributory factor. They advise the safest thing drivers can do is to wait until safely parked before using a mobile, or other device.

An illustrated history of our Local Workhouse



There was a buzz of anticipation within the Townsend Hall as over 100 Members and Guests welcomed U3A member Maggie Wood to present her lecture about the history of our local Workhouse which housed local people with "no place to call home" from c.1836 to 1928. The audience also felt the relief of eased lockdown regulations at the first U3A meeting of 2022 where they were able to mix together socially.

We understood that Shipston on Stour around 1836 was almost entirely an agricultural farming community where close-knit families worked the land and provided casual labouring employment for able bodied men as required.

For unemployed women life was even harder. The Workhouse was built and supported by local benefactors such as Mrs. Elizabeth Townsend of Honington Hall and indeed the original Grade 11 listed building still remains near to the Catholic Church but has been converted to private flats. The Workhouse was built to accommodate up to 300 strictly segregated people but is recorded as having a more usual total of around 200. Conditions were very poor when compared to our modern standards.

Shipston Workhouse was part of a union of 36 Workhouses scattered across this region and housed a variety of poor "inmates" who suffered from physical and mental problems and were perhaps unemployable as a result. At that time there were no other community support facilities available, and they were directed to the Workhouse. Despite the strict segregation, we understood that some "Bastard" children were born to unmarried women and around 1882 the Vicar of Tysoe intervened to assist an Eliza Parker who had four children. We also heard of Emily Wilson, Mother to four children who was forced to the Workhouse when abandoned by her carpenter husband who sailed to New York in 1910 but occasionally sent her money. She went back in and out when able to support herself.

The boys within the Workhouse were partially integrated with Shipston School for some basic education up to 11 years of age and then usually set to work on local farms. The girls were shown some very basic domestic skills and then placed "in service" as live in domestic servants within local houses around the area. Physically or mentally handicapped unemployable people or children remained within the Workhouse. Corporal punishment was severe and widespread throughout and Mrs. Elizabeth Townsend was famed as a local generous benefactor who strived to improve the lot of the poor souls within the Shipston Workhouse.

The lecture by Maggie Wood was very well received and she was given hearty thanks by a fascinated audience who then returned gratefully to their comfortable homes.

Tom Clifton



AGE CONCERN SHIPSTON ON STOUR & DISTRICT

GRANT AVAILABILITY

Age Concern Shipston on Stour & District can offer grants of up to £200 to fund identified needs of residents in the Shipston area. Grants will be made for needs identified in order to make life easier and more enjoyable or to alleviate specific problems.

To be eligible for a grant, residents must:

Live permanently within 10 miles of St Edmund's church (Shipston parish church).

Live either in their own home, in a care home or sheltered accommodation.

Be over the age of 70 on the day that a grant request is made.

To apply for an application form contact:

David Roache, Fallowfield, Lower Tysoe, WARWICK CV35 0BY

Tel 01295 680309

email djroache@buzzinternet.co.uk

Our Dementia Friendly Cafes offer tea & coffee, a chat, friendship & support for people living with dementia, carers, family & friends



**Now Open in Shipston-on-Stour
Every Tuesday morning**

**Shipston Lodge Armistice Close
Shipston-on-Stour CV36 4QG**

**From 10.30am - 12.30pm
Free entry**

www.talkdementia.uk

**Contact Heather & Paul on 01295 688376
or email: talkdementia@mail.com**

**Locally based Voluntary Signposting Support
from experienced Dementia Carers**

SHIPSTON GARDENING CLUB

Now re-opened following nearly 2 years of lockdown!

We cordially invite all previous members and potential new members to a meeting on **Wednesday 9th March 2022 at 7:30** in the **Catholic Church Hall, Darlingscote Road.**

There will be a guest speaker, refreshments and a raffle.

For further information, please contact the membership secretary- Mal 01608 662122



200 Families

Thanks to the generosity of people in Shipston and surrounding villages, since March 2020 we have been able to provide 200 families with food.

The Foodbank is open on Saturday mornings between 10.30am and 12 noon. **You do not need a referral or a voucher just turn up. No-one is turned away.**

In these uncertain times we would like to ask you for your continued support.

Donations of basic items can be left in the church porch **between 9.00am and 5.00pm Monday to Saturday.** There's also a collection point in both the Co-ops.

For information about our current needs please check on our Facebook page or our website:

www.facebook.com/ShipstonFoodBank

www.shipstonfoodbank.org.uk

Shipston-On-Stour

Women's Institute

On Wednesday 2nd February, Shipston WI was introduced to Gilly Mara who came to talk about her experience as one of a team of five women who were the first to row New York to Falmouth in 2016 in an unsupported boat.

West to East is the 'wrong way': the crossing is usually done from East to West taking advantage of the ocean currents. Unsupported means that if anything untoward happened, they were on their own on the wild and wasteful ocean.

Gilly's 'journey' to 7th June 2016 began fourteen years before when she suffered a devastating and life-changing accident whilst walking in New Mexico. She got lost, fell 60', bounced seven times, and spent the night alone and rain-soaked until rescued the next day. She had many broken bones – fractured skull and broken pelvis – and gashes, but the most crucial injury was to her spine – her spinal column was compacted, but thankfully not severed. Told it would be twelve months before she could take a step, Gilly was back at university in five weeks! Gilly is very competitive and determined. She is a world champion kayaker, an Olympic medalist and her doctorate was on the subject of trainers!

In 2012 Gilly was invited to join the group rowing the Atlantic and was chosen after a gruelling selection process. Each crew member had a specific role besides the ability to row, and Gilly's was the fixer, the problem solver: she had to be tough mentally as well as physically. They rowed non-stop – 2 hours rowing, 2 hours off, 20-24 strokes per minute, round the clock. Sleep was at best one-and-a-half hours, food was rehydrated mush. Monotony and sanity were saved by a packet of digestive biscuits!

Falmouth was reached on day 49 – six more than their target of 43 days. The first team of women to make the crossing. They rowed against the currents, against the winds, and against all that the Atlantic could throw at them. It was and remains an amazing achievement.

The meeting continued after tea break and the President welcomed new members and visitors.

There will be a coffee morning in The George on 15th February and a craft and produce sale is proposed in March. The Branch continues to raise money to celebrate its 100th anniversary in October.

The next meeting will be on Wednesday, 2nd March at 7.00pm in The Catholic Church Hall, Darlingscott Road. The speaker will be talking about Scott of the Antarctic. Visitors are welcome.

Nicci Williamson



Shipston Town Band

To encourage the development of our youngsters and to let other local young people know of opportunities that may be available, Steph Wilson, our junior band leader, liaised with Brass Band England's development officer Sheila Allen to arrange a visit to our local primary schools by Flora Brass.

Flora Brass comprises students from the Royal Welsh College Of Music and Drama in Cardiff. They are an established brass quintet and travelled up to perform at Shipston Primary School, Brailes CE

Primary School and Acorns Primary School at Long Compton on a whistle-stop tour as part of the Brass Foundations Programme.

Their concerts included pieces such as the theme from 'How To Train Your Dragon' and 'Bear Necessities' from the 'Jungle Book'. The children were enthralled, and Steph Wilson has already had parents ringing her up to see if their children can learn to play.

If you are interested in learning a brass instrument, please visit shipstonband.co.uk for more information.

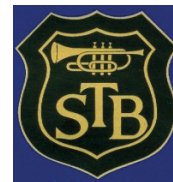

Shipston Probus Club

'Woman in a Man's World'

Lynn Hilditch entertained us with an account of her unusual and varied career in the RAF with insights into the struggle for acceptance of females in a male-dominated profession.

After initial training as a nurse, Lynn sought something more exciting for a woman in the 1960s: a career in the RAF. At this time women made up only 9% of the RAF and there were only three females on her initial training course. Frequent sexist comments to women by males in charge that would not be tolerated today were common, not least the expectation that the women would be the ones to make the coffee and sandwiches! A more damning but repeatable example: when reporting that a runway was beginning to show 'rutting around the edges' came a smart response, "Can we all come and watch?"

After completing training in the Central Air Traffic Control School Lynn gained experience at several RAF bases -Syerston, Wymeswold and Shawbury. A posting to Cyprus in 1972 coincided with the invasion of that island by the Turks and the outbreak of war; married staff were recalled to live on the base and Lynn's experience as a nurse was pressed into use again. At this time a tragic accident occurred during a formal fly past; a jet plane crashed, killing the pilot and navigator. At the subsequent inquiry, the ability of a female traffic controller to visually assess the height of an aircraft was subject to doubt by male officers and had to be confirmed by a repeat fly past!

By the time Lynn ended her career with posting to Brize Norton and spells at GCHQ and MI5, about 40% of RAF personnel were female. No doubt today, any obvious sexism in the RAF, as with the rest of society, is viewed with disapproval, but perhaps even now we still have some way to go to achieve complete parity?

Probus members, some with their own memories of life in the forces, showed their appreciation of a lively and fascinating talk by their many questions before retiring for a good lunch at the White Bear.



STOUR VALLEY LION'S CINEMA



Certificate U - Emma Woodhouse is Queen Bee in her small town with no rivals. Romance/Comedy with Bill Nighy, Miranda Hart.

TOWNSEND HALL

FRIDAY 4th March, 2022 at 7.30pm

Advance Tickets £5.00

From: A. Clarke Electrical, 27 High Street, Shipston On Stour.

Covid restrictions - please wear a mask/hand sanitise on arrival.

Raffle and drinks.

Any enquiries please email: stourvalleylions@gmail.com

u3a

MEET SHIPSTON AREA U3A!

(AND FIND A NEW INTEREST?)

**Interest Group Displays,
Meet Group leaders & members,
Join or renew membership.**



TUESDAY

22 MARCH, 2022

TOWNSEND HALL,

SHEEP STREET, SHIPSTON-ON-STOUR

10.am To 2.30 pm

FREE TEA AND COFFEE

Hope to see you there!



52 Sheep Street, Shipston-on-Stour, Warwickshire. CV36 4PE



*Richard Leach's
Street Band*

Friday 18th March 2022

Doors Open 19:30 for 20:00

Fully Licensed Bar

Tickets £10 from

- o Clarke Electrical Services, 01608-661394, or
- o For online booking, visit ticketsource.co.uk or townsendhall.co.uk, or
- o Email / Phone David: ds@pinnegards.com; 07511-694733

SHIPSTON ON STOUR AREA

u3a

Registered Charity No 1170969

TUESDAY 26 APRIL, 2022 2 pm TOWNSEND HALL



Sculpture in Nuneaton Market Place by John Lettis in 1985

George Eliot and Warwickshire History

How one of our greatest novelist's work was influenced by her Warwickshire upbringing; it includes extracts from her books.

A talk by David Paterson

(Former Head of History at King Edward VI College, Nuneaton and Chairman of the Nuneaton Branch of the Historical Association)

**Visitors are welcome
Entry including refreshments £2**

Wildlife Article

Frogs, Ponds, Spring and Things

I was amazed a couple of years ago, when, only 2 weeks after we'd installed a small pond in our garden, a frog arrived and became resident over the Summer. The pond has also given us great pleasure with its purple irises and pink water lilies. We've made a few changes along the way – making a gradually shallowing corner where birds can more easily access a drink or a bath and adding a small pump to ripple the surface, which has helped to keep it ice-free in winter, reduce the algae and give it more life. The frog has hibernated at the bottom of the pond (so it's probably a male) and we're hoping, as the welcome Spring arrives, to see it more active again and maybe spawn this year too, if the right partner arrives! We're keeping our fingers crossed. At any rate, we'll be looking forward to watching parent birds teaching their chicks how to access the water.

Hedgehogs are creeping out from their hibernation around now. They will be waking up hungry and need our help with a reliable source of food and water. Thank you to those who got in touch last year with their hedgehog sightings. Shipston is probably supporting a fair population in half a dozen garden areas, but without a proper study, it's hard to quantify these animals who can walk a couple of kilometres each night. Please



drive gently after dusk to give these endangered animals a chance to survive.

Swifts have already started their flight northwards. Thank you to those who contacted me about their need for more nest sites. I visited

eight locations to assess the potential for successful nest box siting. At the beginning of December Phil Wragg was presented with the winner's two nest boxes by Richard Gray (Chairman of SVWAG). Watch out for Swift Awareness Week in July when I'll be leading a Summer Evening Swift Walk to enjoy the return of our fantastic summer visitors.



Other news:

- **Lawns 2 Mow** (who cut the grass of St Edmund's church yard) has agreed to desist from using herbicides and pesticides in the grounds so that purposely sown wildflowers and insects can thrive.
- **The Town Council** is working with the landowners, **Warwickshire Wildlife Trust** and others to transform the gifted Corn Mill Meadows into a wildlife-friendly environment.
- The newly formed **Stour Valley Wildlife Network** is linking local community groups who are spearheading projects to support wildlife. A newsletter will be coming soon!

Do get in touch if you'd like to know more or contribute towards this growing area of interest.

Jacey Jackson 01608 661288

Stour Health and Wellbeing Partnership

The Stour Health and Wellbeing Partnership (SHWP) are pleased to advise that they have launched their website (<https://www.shwp.org.uk/>) and Facebook page (@StourHealthandWellbeingPartnership).

Within the website there is an easy to use Community Directory to help you find health and wellbeing information. In addition there is a News section that is regularly updated with useful articles and information from our Partnership members.

There is also an updated list of FREE activities as well as the Dr Sue Pritchard Memorial Challenge Walking Quiz (see page 16) to complete to claim a FREE family swim session. Just take your answers to Shipston Leisure Centre on Darlingscote Road to claim your family swim session.

Additionally, the Stour Health and Wellbeing Partnership (SHWP) is looking for a new chair of its Children, Young People and Families work stream. Candidates should have experience of this area. This is an exciting opportunity to lead the search for new solutions and to play a major role in helping residents to live longer and better. Applications to Trevor Russel at t.w.russel@hotmail.com by 7th March.

Bob Armstrong, Chair of Trustees

Time to get walking again!

At this time of year, we start to think about the mud drying up and getting out to walk in the beautiful English Countryside again, but where to find new and interesting walks?

Walking in Warwickshire (<https://www.walkinginengland.co.uk/warwickshire>) has hundreds of walks to download and print for free. It also has books of walks, details of all the walking groups in the county and much more. Whether you want to walk on your own or with a group all the information is there in one place.

There is so much walking information on the web but it is difficult to find. Walking in Warwickshire (part of the Walking in England website) has brought it together in one place so whether you are walking from home, or away on holiday, you will be able to find a walk suitable for you.

With walks from half a mile to twelve miles plus long, and a note of suitability for pushchairs and wheelchairs, everyone can find a walk to enjoy.

So home or away, check out the websites and get walking!

John Harris

john@walkinginengland.co.uk
www.walkinginengland.co.uk



ARE YOU LOOKING FOR RENTAL ACCOMMODATION IN SHIPSTON-ON-STOUR?

**FLATS ARE AVAILABLE IN RAINBOW
FIELDS – ORBIT INDEPENDENT
LIVING HOUSING SCHEME**

For those over 55.

**ONE BEDROOM FLATS COMPRISES LOUNGE AND
BEDROOM WITH SEPERATE BATHROOM AND
KITCHEN**

**ALL ROOMS HAVE A WARDEN CALL SYSTEM AND
THERE IS A FULL TIME SCHEME OFFICER ON SITE**

LIMITED PARKING

FOR FURTHER DETAILS PLEASE

TELEPHONE: 01608 661682



Shipston-on-Stour Probud Club

**Are you a retired/semi-retired man interested
in meeting like-minded people?**



Lively and varied talks from guest speakers



A drink at the bar followed by a good lunch



Friendly company

We meet every other Friday at 10am - for date and venue
of our next meeting, visit our website or get in touch.

Visit - probushipstononstour.wordpress.com

Email - tonyjoint73@hotmail.com

Call - Tony Joint on 01608 663407

See you there!



Calling all allotment holders

**The annual meeting of
Shipston-on-Stour Allotment Holders
will be held at 7.00pm
on Tuesday 29th March 2022
in the Council Chambers at New Clark House**

All allotment holders welcome.



**Any queries, please contact
Diane Neath, Assistant to Town Clerk
on 01608 662180 or
email: assistant@shipstononline.org**



L&Q

**FREE ACTIVITIES
IN SHIPSTON ON
STOUR**

Dr Sue Pritchard Memorial Challenge

New health & wellbeing opportunities brought to you by the Stour Health & Wellbeing Partnership in partnership with Sport England and L&Q

For further information and to book please email:

juliareeves@everyoneactive.com or call 07514492468

Activity	Day	Time	Location
Seated Exercise Class	Tuesday	10:00am	Townsend Hall
Gentle Walk	Tuesday	12:00pm	Shipston Town Council
New Age Kurling	Wednesday	2:00pm	Townsend Hall
Pilates for Complete Beginners	Friday	9:30am	Townsend Hall
Board Games Social Afternoon	Friday	2.30pm	The Coach & Horses



**everyone
ACTIVE**

Everyone Active manages these facilities in partnership with Stratford-on-Avon District Council.

www.everyoneactive.com [facebook](https://www.facebook.com/everyoneactive) [instagram](https://www.instagram.com/everyoneactive) [linkedin](https://www.linkedin.com/company/everyoneactive) [youtube](https://www.youtube.com/everyoneactive)

Shipston Angling Club

The Club was established in 1953 and next year it will be celebrating its 70th anniversary which is a long time for a small club that started with a relatively small stretch of river. The oldest surviving club book that I have in my collection is from 1974 to 1975 and the way that the club has carried on and grown is quite remarkable.

The club has many stretches of the River Stour now that anglers can fish along with 3 pools at Aston Magna and 2 stretches of the River Avon at Seven Meadows in Stratford-upon-Avon and Charlcote. All these venues are set in typical local unspoilt habitat, where it's not just about angling but being at one with nature and at this time after all that's gone on over the last couple of years it's just perfect escapism.

Shipston has more than 200 members and this has grown year after year, even more so through the Covid pandemic where it was accepted that angling, being an outdoor recreation, was good for the mind. We also attracted many families by offering family membership which makes it a cheaper hobby to take up which is all-important.

The club runs organised matches nearly every week as well as midweek matches in the better months. We also have run a few junior matches but this has been hampered by the lockdown rules and this year we have planned to get back to organising more junior events.

Shipston Council last year helped us with the opening of the river to make it more accessible to all and this has opened up the river frontage for all to see and the addition of one platform for less able-bodied anglers was a huge success. We are planning to add more of these for the older anglers and for junior tuition both there and at Aston Magna where we have

started already. The Environment Agency also stocked one pool with many varieties of fish including bream, tench, roach and rudd and they also continue to be highly supportive of the club.

We hold several meetings each year and have a very proactive committee that makes it all work and our plans for 2022 include talks from top anglers and hopefully one from the Environment Agency, the ever-popular annual duck race from the bridge in Shipston and of course the annual FISH 'n' FROLICS festival which has been going for 9 years without fail. This year the Duck race will be in July (date tbc), the 3-day fishing festival is on 22nd, 23rd, 24th July and the music festival is on 30th July

and there will be the usual food stalls etc that make it a fun day out that's also free entry. This is a community event that is open to all, not just anglers, and the event is not focused on angling at all.

To finish, the club now has two trained level two coaches and will have a further two level-one coaches that will be able to teach or offer help learning the skills needed to take up the sport or for learning how to fish rivers like the Stour and the Avon along with lessons up at Aston Magna

The Sports club details can be found on www.shipstonangling.com or visit Shipston-on-Stour and District Angling Club @ shipstonangling.



Shipston Music Society

By the evening of February 19th members of the Shipston Music Society were very relieved that the weather conditions had eased after the recent storm, thus enabling them to attend a piano recital by Charles Matthews. He studied at the Royal College of Music in London and as organ scholar at Trinity College, Cambridge and has won numerous awards. In 1999 he received First Prize at the Franz Liszt Organ Interpretation Competition in Budapest. He is an organ tutor at the Birmingham Conservatoire and is in great demand as a piano accompanist; he featured a few months ago on TV accompanying a young Chinese violinist in a performance of "The Lark Ascending" by Vaughan Williams.

He opened his programme with Barcarolle no. 4 by Faure, a delightful piece with an arpeggio-like pattern to accompany the melody. In the middle section, the sonorous legato melody is passed from one hand to the other before references to the opening theme bring the piece to its finale. Next, we heard Chopin's Waltz in Ab Op. 69 no.1 which, with vitality and excitement, provided an excellent contrast.

The final work in the first half was "Mystical Swan in Blue" by Fiona Frank which is a seven-movement sonata. After an extraordinary encounter at twilight with a swan on the banks of the River Wye in January 2021, in which "Her dazzling white feathers shone in the misty blue twilight..." Fiona managed to capture some of this in the varied styles and

contrasting features. From the lilting "barcarole – type" movement to the powerful, rhythmic and syncopated surge towards the finale, this prompted much discussion during the interval. Pianistically it is very challenging!

The main composition in the second half was "Schwanengesang" (Swan Song) by Schubert, arranged by Liszt. It is a collection of 14 songs composed by Schubert near the end of his life and published after his death. The themes are varied and the original compositions too are in contrasting styles. With Liszt's arrangements for solo piano, this becomes a real "Tour de force" and the performance given by Charles displayed his formidable technique, sense of style and ability to convey Schubert's mastery of the song cycle to the listener.

Bringing the recital to a close was "The Swan" from "The Carnival of the Animals" by Saint-Saens arranged by Siloti. Alexander Ilyich Siloti was born in Ukraine in 1863 and died in 1945. This arrangement was yet another example of a simple melodic line being expanded into a complex and advanced major performance piece. The musical skill and stamina required is unbelievable but Charles showed no sign of being tired and was happy to chat with people afterwards. What an evening.



Shipston Primary School

Shipston On Stour Primary School



SKIPPING MARATHON

As part of our Blood Heart topic last term, Year 6 set themselves the goal of completing 1 hour of skipping per child. Every Friday afternoon, we skipped for 30 minutes to an hour to improve our technique and learn new skills.

The skipping marathon was to raise money for the British Heart Foundation, a charity that helps people with heart conditions. Year 6 were aiming to raise as much money as possible.

We are proud that we raised an astonishing amount - £638! It was hard work, but we had lots of fun and Year 6 really enjoyed raising the money for such an important charity, even if some of us completed the task at home!

We are grateful for all the donations as the money raised will help children and adults with all sorts of heart problems. Every child who completed the task received a certificate and as a reward for raising over £50 individually, the two of us received a digital skipping rope as a reward.

By Morgan and Daisy

FIRE SAFETY WORKSHOPS

Swans class had a fire safety talk this week from Wayne, who works at Leamington Spa fire station and used to be a police officer.

He reminded the children of the previous learning they had received on fire safety in Year 1 and then the children had to work on spotting fire hazards in the home. The class discussed why hoax calls are made and how this can put everyone at risk, including ourselves and the firefighters. The children have been given booklets to check the safety of their own homes.

CAR IDLING CAMPAIGN



One of the activities Shipston Primary has to complete as part of the Warwickshire Safe and Active school award is to raise the awareness of idling cars near schools.

Warwickshire County Council's Road Safety Education Team and Shipston Primary's School Council have launched a campaign to improve the air quality around our school at the start and end of the day.

We are now encouraging everybody who travels by car to prevent idling by switching off your engine. Idling means leaving a car engine running whilst it is stationary. When stationary for more than 10 seconds please consider switching off your engine.

According to Living Streets and the British Lung Foundation, there are several benefits to our children and families when we prevent idling:

- By preventing the breathing in of harmful fumes from idling vehicles, we can reduce the risk of health problems such as

lung and heart disease, strokes, and respiratory illnesses.

- The average emissions of a passenger vehicle are 4.6 tonnes of carbon dioxide a year – by switching off your engine you can help to reduce this figure.
- Drivers can save money by not wasting fuel when a car is switched on unnecessarily.

For more information about idling cars, Living Streets have produced an anti-idling toolkit

which can be found at: <https://www.livingstreets.org.uk/getinvolved/campaign-with-us/tackle-air-pollution>

YEAR 6 INUIT ART

The Inuit are indigenous people who live in the Arctic region, an area that includes Alaska, Canada and Greenland. Artwork made by the Inuit includes pictures, carvings, sculptures and prints. Animals, cultural myths and legends are the main sources of inspiration. 'Inuit' is a companion project to Frozen Kingdoms.

In this art & design project, Year 6 have been taught about the Inuit way of life, including some of their cultural and artistic traditions.

Printmaking is a more recent addition to Inuit art, starting in the late 1950s with the help of James Houston, a Canadian artist and government administrator. At first, stonecuts were used to print images. Later, stencils were used. Below are some examples of Year 6 stencilling.

In February, Year 6 were studying Inuit art. They were performing stencilling; this is one of the more recent types of art that the Inuit produce. Many prints were successful and the children had a fabulous afternoon learning about Kenojuak Ashevak, who made an excellent print called 'The Enchanted Owl.'

by Isla (Flamingos)

FOREST SCHOOL

55 saplings have been planted in Forest School, including silver birch, elder, rowan, dogwood, hawthorn, blackthorn and dog rose. These trees have been planted to extend the hedge that forms part of the boundary of

Forest School. Hedges have a very important role to play as they support up to 80% of our woodland birds, 50% of our mammals and 30% of our butterflies.

This is the first stage of our green canopy that we will be planting to celebrate the Queen's Platinum Jubilee. More trees are due to be planted in the spring.

Christian Hilton, Executive Headteacher



Shipston High School

Shipston High School has been very busy through the start of 2022. Year 11 students are focused on their forthcoming examinations, and all are welcoming the opportunity of the first set of traditional examinations since 2019, following Covid-19 disruption in 2020 and

2021. Students are studying hard in lessons, as well as attending extra-curricular sessions to boost their knowledge and skills. The atmosphere in the year group is ambitious and determined, and we all wish them well at this time.

Both years 7 and 8 have enjoyed careers days this term. The usual timetable was suspended to allow students to focus exclusively on their futures. Students worked in teams to try and decide what they would like to do in the future and what skills they would need to achieve their goals. It has been an energetic, motivating and interactive couple of days and students thoroughly enjoyed the sessions.

We are extremely grateful to local companies and employers who contribute to this event, providing real-world insight into employment, business and aspirations and career paths. Thank you to everyone involved.

Shipston based company Pink Connect are one of our main contributors, and the school is especially grateful to James Pink who is donating computers to the school to help every student to have their own personal access to a computer. This is incredibly generous, and shows a real commitment to the school, community and our young people; thank you.

During March families will be informed of their school place allocation by the Warwickshire admission service, and we

look forward to meeting and welcoming our new intake just as soon as circumstances allow.

Shipston High School is once again significantly over-subscribed, with more families seeking a year 7 place than places available. The school is very aware of our desire and responsibility to provide good school places to local families, and so we have approached the local authority school Admissions team to extend our offer this year. We have negotiated to offer places to families within our priority area who otherwise may have missed out due to the overwhelming popularity of the school. Place numbers necessarily must have limits due to the physical size of the site, but we are delighted to extend the places available for this year.

Finally, it feels really positive to once again be working with other local schools to provide friendly and competitive sports fixtures. Students have been enjoying the opportunity and it is great to see this essential part of school life returning to our playing fields.

Gavin Saunders, Headteacher



Shipston Medical Centre

Medical Centre t: 01608 661845

COVID Vaccination Update: what should you do if you have missing vaccinations?

Vaccinations given in England

For issues with vaccination records from vaccinations received in England, patients should contact 119, and take the following steps:

- Call 119.
- Select option 1 (England).
- Select option 4 (To report an issue with your COVID vaccination record).
- Ask to speak to the Vaccination Data Resolution Service (VDRS). You should get a call back within 21 days.

The VDRS team will aim to contact the patient within 21 days. They will make three attempts to contact you (however this is not a number you can call into). If they are unsuccessful in contacting them, then you will need to call 119 and make a new referral. The previous call will be closed after the three attempts to contact you.

FAQs for the Vaccine Data Resolution Service can be found here: <https://www.nhs.uk/contact-us/vaccine-record-help/>

[nhs.uk/contact-us/vaccine-record-help/](https://www.nhs.uk/contact-us/vaccine-record-help/)

If any patient wishes to lodge a complaint regarding the VDRS service, then can they email: england.contactus@nhs.net

If you had your vaccination at Ettington or later in Stratford then send your enquiry into swg-tr.shipstonrecords@nhs.net

Vaccinations given not in England

There is a service in place also for vaccinations that have been received outside of England, of which information can be found at the following page: <https://www.nhs.uk/conditions/coronavirus-covid-19/coronavirus-vaccination/tell-nhs-about-coronavirus-vaccinations-abroad/>

You can use this service if you:

- are aged 18 years old or over
- have an NHS number
- have received one of these MHRA-approved vaccines outside of England - Oxford/AstraZeneca (Vaxzevria), Pfizer/BioNTech (Comirnaty), Johnson & Johnson (Janssen) or Moderna (Spikevax)
- Be able to attend the face to face

appointment with photographic ID (Passport or UK Driving Licence) and evidence of their vaccination record.



Shipston Medical Centre

Unfortunately, there are no sites available in Coventry and Warwickshire for this and you may need to travel to a site in order to be able to get this authorised. We will hopefully look to have more local appointments available for this in the near future.

Where you are unable to have your overseas vaccination recorded. For example, because you live too far away from one of the vaccination centres offering this service, you can still access subsequent doses for which you are eligible, either through attending a walk-in (if you already know which vaccine type you require, as well as the appropriate interval period), or through seeking advice from your GP about which subsequent vaccine(s) you need. If you need any further vaccinations please take any proof of vaccinations administered abroad with you to the site for any future vaccinations.

District Council update

As I write we are about to have Full Council where we will set the part of the Council Tax you pay for Stratford District Council services (approximately 7% of the total) for this year.



The bill comes from us – but most of the money is spent at Warwickshire County Council level and by the Police and Crime Commissioner – I'm getting my apology in first!

As April looms we all know that the cost of daily life for all of us is going to go up. Inflation is running at 5.5% - I was a student the last time it was this high – but as I was at Liverpool prices were reasonably cheap (well the beer was....).

The cost of electricity and gas is going to rise and for many that means a choice between heat and eat. If you can shop around for a new tariff – do so – there are good prices to be had. Act on Energy can give advice and help on insulation, grants and help with bills.

There are payments coming from the government via your council tax (£150 for all and a discretionary amount on top of £200). Just as during the pandemic the wonderful people in Revenues and Benefits at Stratford District Council will work over the weekend to get the software in – so you are paid or discounted as quickly as possible. I am biased – I am portfolio holder for the service, please call me if you need help.

As ever – don't get hungry – Foodbank is there for you

Jo Barker, District Councillor, Shipston South
07748 968712 | jo.barker@stratford-dc.gov.uk

Jo Barker and Trevor Harvey take it in turns to write this column

County Council update

Today (Wednesday 16 February) we are debating the Community Hospital Inpatient Review at Warwickshire County Council.



As we all know there are really exciting plans for the Ellen Badger Hospital as well as the Nichol Unit in Stratford. Today the Adult Social Care and Health Committee has supported the continuing supply of community beds. This is the beginning of the process of engagement – so it's time to get your views in! The committee has added the choice of having MORE beds to the review! Result!

There will be a 12-week consultation – probably from June – where we can all throw our views into the pot to get the right healthcare for us and our growing population in Shipston.

The EBH will have Inpatient, rehab and treatment - with potential cover from GP's who will be on-site in the new Medical Centre and we will look at exactly what is going to go into the EBH on top of the inpatient offer.

My real wish is to see people kept safe and healthy as close to home as possible – understanding that community hospital care is holistic and improves resilience to return home.

New ideas – please let me know what you would like done; with the circulation of the High Street; youth provision now that the school has closed the YC building; details and pictures of leaks and sewage - we will get Shipston poo and leak-free!

Jo Barker, County Councillor, Shipston
07748 968712 | jobarker@warwickshire.gov.uk



Shipston-on-Stour Cricket Club are looking to appoint a groundsman to join our team on a flexible, part-time basis, approximately 10-15 hours per week, £10ph (negotiable) to support our successful, friendly, Premier League club.

Responsibilities include regularly liaising with the committee, maintaining the square and preparing pitches for a variety of matches throughout the season. Outfield maintenance is not part of the responsibilities of this role.

All necessary ground equipment is provided by the club. No experience is necessary as experienced support will be provided. The successful candidate should be willing to train through to a nationally qualified status. All training will be paid for by the club.

If interested please contact Dave Murphy on 07973 468334.

"Still time to plant a tree for the Jubilee" says Warwickshire's Lord Lieutenant

Tim Cox, Lord Lieutenant of Warwickshire (the Queen's representative in the county) is encouraging individuals, schools, community groups and businesses to participate in The Queen's Green Canopy. This tree unique tree planting initiative forms part of commemorations to mark the Queen's Platinum Jubilee.

"The Queen's Green Canopy is a brilliant project and a wonderful way to mark Her Majesty's Platinum Jubilee, which celebrates a remarkable 70 years on the throne - the longest of any monarch in this country," said Tim Cox. "This exciting scheme means many individual trees will be planted, but will also generate, we hope, more ambitious schemes such as new woodlands. The traditional British planting season runs up until the end of March, and trees can still be planted as part of The Queen's Green Canopy project until the end of the year, so there is still time for people to 'plant a tree for the Jubilee', or to plan their planting projects as a community group, school, business, or organisation."

The best time to plant a tree is during the traditional planting season, which happens from early October to the end of March each year. To get involved in planting a tree over the next few weeks during peak planting season, or to set up a commemorative plaque, visit <https://queensgreencanopy.org/get-involved/>, and remember to add your tree to the map which will be presented to Her Majesty the Queen as part of the Platinum Jubilee celebrations: <https://queensgreencanopy.org/map-education-hub/qgc-map/>

Your Town Councillors

Ian Cooper, Mayor
Finance Working Group Chair

t: 01608 663785

 e: ian.cooper@shipstontowncouncil.org

Marianne Westwood, Deputy Mayor

t: 01608 662223

 e: marianne.westwood@shipstontowncouncil.org

Ronnie Murphy

t: 01608 664518

 e: c/o clerk@shipstononline.org

Paul Tesh
Planning Committee Chair

t: 07711 433566

 e: paul.tesh@shipstontowncouncil.org

John Dinnie

t: 01608 664590

 e: john.dinnie@shipstontowncouncil.org

Jo Barker

t: 07748 968712

 e: jo.barker@stratford-dc.gov.uk (for town and district matters)

Peter Cox
General Purposes Working Group Chair

t: 07973 442552

 e: peter.cox@shipstontowncouncil.org

Peter White
Communications Working Group Chair

t: 07792 507168

 e: peter.white@shipstontowncouncil.org

Gerry Kelly
Planning Committee Vice Chair

t: 07471 687720

 e: gerry.kelly@shipstontowncouncil.org

Tim Shickle

 e: tim.shickle@shipstontowncouncil.org

Tony Booth

 e: tony.booth@shipstontowncouncil.org

Shirley Madams

 e: shirley.madams@shipstontowncouncil.org

Vacancy

Useful Contacts

Community Links Transport	01789 264491
Shipston Library:	0300 5558171
- 24/7 renewal line	01926 499273
Highways customer services	01926 412515
Severn Trent Emergency Line:	0800 7834444
Shipston Volunteer Transport Scheme	01608 663122
Shipston Leisure Centre	01608 662354
Shipston Medical Centre	01608 661845
- Out of hours	111
Shipston Forum	01295 788655
Shipston Link (local transport)	01386 593446
Shipston Recycling Centre	01926 412593
Stratford District Council	01789 267575
Townsend Hall	07514 704057
Warwickshire County Council	01926 410410
UCHW Hospital	024 7696 4000
Warwick Hospital	01926 495321
Local police (non emergency)	101
Shipston Police Safer Neighbourhood Team:	01789 444670
shipston.snt@warwickshire.pnn.police.uk	
Churches of Shipston:	
Stour Valley Baptist	01608 664876
Our Lady & St Michael	01608 685259
St Edmund's	01608 661210
Methodist Church	01295 257193

Shipston-on-Stour Town Council

New Clark House, West Street, Shipston-on-Stour, CV36 4HD

Town Clerk

 t: 01608 662180 e: clerk@shipstononline.org
County Council Contact:
Councillor Jo Barker

 t: 07748 968712 e: jobarker@warwickshire.gov.uk
District Council Contacts:
Councillor Jo Barker (Shipston South)

t: 07748 968712

 e: jo.barker@stratford-dc.gov.uk
Councillor Trevor Harvey (Shipston North)

t: 07969 167720

 e: trevor.harvey@stratford-dc.gov.uk

Something exciting to share?

If you have a story that's relevant to Shipston residents, please contact the editor, Chris Rowland on 01295 788655 or email: forum@shipstononline.org

To request posts on the council's Facebook and Twitter feeds, contact Peter White (details above).

Forum copy deadline:
Second Monday of the month

– but the sooner you can notify the editor of a potential story the better.

The Shipston Forum is produced monthly by the Town Council.

While every effort is made to ensure information is accurate, the Town Council and its contractors do not accept responsibility for material submitted by readers or third parties and does not endorse any organisation or event publicised. Contributions may be edited to fit available space.

L&Q

Dr Sue Pritchard Memorial Challenge Walking Quiz

Start at the Shipston Town council offices.

Please take care when crossing roads.

HINT: If there is an * look for a sheep plaque.



1. How long can you stay?
2. I'm not new I am...
3. What is the pub called?
4. What did number 19 used to be?*

CARRY ON ALONG THE ROAD

5. Who used to come to this school?*
6. I'm not old I am...
7. How many gargoyles are on the Methodist church?
8. Which fruit used to be grown here?
9. How many horses are at the pub?
10. When was Edward here?
11. Who founded the cottage hospital?*
12. What colour is the bear?
13. Who used to live at the Bower house?*
14. What colour is the horse?

WALK ALONG THE ROAD BETWEEN THE BANK AND THE SHOPS TOWARDS SHEEP STREET. TURN LEFT

15. Number 1 Sheep Street, who used to live here?*
16. Number 5 Sheep Street used to be what?*

CROSS OVER TURN RIGHT AND HEAD DOWN SHEEP STREET

17. What's in my hand?
18. How many arches are there?

CROSS THE ZEBRA

19. What was the library in 1685?*
20. Where can we remember outside of the church?
21. Through the Arch, what can you see? Look above, when was I built?*

Please take your answers to Shipston Leisure Centre to receive a free family swim session.

22. How many trees on Telegraph Street triangle?
23. How far to London?*
24. Thomas the tank engine might have visited this road

CONTINUE UP THE LAST ANSWERS ROAD

25. How much is the close?
26. Where is the Rainbow?
27. When was the Black Horse Inn built?*

CROSS AND CONTINUE UP TILEMANS LANE

28. Which 2 animals are on the school sign?
29. Which animal is at the children's Centre?

TURN LEFT ALONG THE PATH JUST AFTER THE CHILDREN'S CENTRE

30. Which games can you not play?
31. How many large arch windows do I have?

FOLLOW THE PATH AND TURN LEFT AFTER THE GATE

32. Who can you call for bus info?
33. I'm tired, if I take a seat which city can I see?

CONTINUE ALONG THE ROAD

34. What was kept in the Shipston pound?
35. How many fingers on the signpost?
36. How far is it to Banbury?
37. The opposite of East
38. Which number can you visit the vet at?



**SPORT
ENGLAND**



**everyone
ACTIVE**